

**Project Specifications**

Bedrooms: 4  
 Bathrooms: 4  
 Heated sqft: 3,218  
 1st Floor: 1,902  
 2nd Floor: 1,316

**Overall Dimensions 46'x 81'**

- 1 Kitchen 16'-6" x 17'-0"
- 2 Living Room 15'-6" x 17'-0"
- 3 Dining Room 13'-0" x 13'-0"
- 4 Master Bedroom 14'-0" x 15'-0"
- 5 Study 13'-0" x 12'-0"
- 6 Bedroom 1 14'-0" x 13'-6"
- 7 Bedroom 2 14'-0" x 12'-6"
- 8 Bedroom 3 13'-0" x 13'-0"
- 9 Family Room 17'-0" x 11'-6"



First Floor

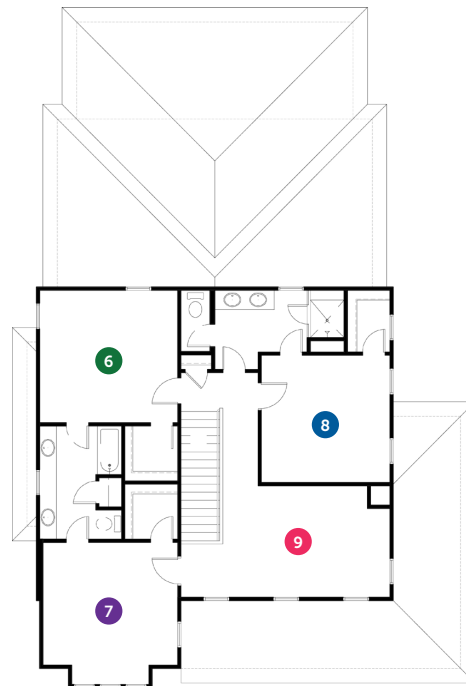

Second Floor



**HIGH TIDE**  
 DESIGN GROUP

Disclaimer: All dimensions and square footages listed are approximate. All rights to these drawings are owned by High Tide Design Group. These drawings are meant to be representative and are NOT FOR CONSTRUCTION.